



FROM OUR CAMPAIGN CHAIR: WAYNE SCHILSTRA

Are we asking for money or are we presenting an invitation to participate in the mission and vision of Cairn Christian School?

In our bi-weekly Cabinet meetings we are being inspired to do the latter by reflecting on *A Spirituality of Fundraising* by Henri Nouwen, who encourages us to “declare what we believe in such a way that we offer others an opportunity to participate with us in our mission and vision.”

Yes, the *Building the Way Campaign* addresses necessary projects to meet program and facility needs

and the elimination of debt. But more importantly, Cairn Christian School instructs students to see and know that Jesus is Lord of all; that students have an important role to play in this world; and that they have been given gifts and abilities in order to be agents of love and reconciliation in His world. Now that’s a mission and vision worthy participating in!

God is able to provide you with every blessing in abundance, so that by always having enough of everything, you may share abundantly in every good work. 2 Cor Cor. 9:8

SPACE TO LEARN

Nan Baker
Junior Kindergarten Teacher
Smithville Campus

If you are like me, you love to plan! As a teacher, I love to plan the classroom environment, monthly themes, outlines of lessons, and daily “WOW factors” to engage the children in learning! I love to implement those plans effectively. It’s fun, especially when the educational targets are met and the kids make connections in their learning! It’s rewarding when the children reflect in our sharing circles about those connections! That’s my joy as an educator!

This year and last, space issues have made the planning and implementing of JK and SK programming highly challenging. We have run out of space! We have been blessed with an abundance of children. Thirty eager students are enrolled in JK this school year, and another 30 in SK, but we don’t have room to accommodate them. It is said that the classroom environment is the “third teacher” along with the child’s parents and the classroom teacher. I agree 100% that the learning environment is so very important, as the space and materials also speak to students.

(Continued on next page)

PRAY

GIVE

VOLUNTEER

SUPPORT

GROW



We work hard to create environments that are inviting, engaging, and interesting for our students. It is always my hope that the classroom has space to accommodate children alone (when they need it), in pairs, in small groups, and in large groups. Lately, it has been impossible to plan for these different kinds of learning experiences.

Thankfully, Mr. Huinink has given up his office so SK and JK take turns to use that space as an overflow classroom. Also, Muddy Mondays and Forest Fridays are outdoor learning opportunities where the whole class can go together to learn in an outdoor environment with no walls or ceilings that crowd us in. During the winter months though, when it is too cold for the young children to be outside for long periods, it is a bit tricky to find a space big enough on those days that all 30 kids come to JK and SK.

Recently, our administration had to make the tough decision to close registration due to limited space, when two new families wanted to join our Early Years program in January. Also, some of our current families wanted to increase the number of days to send their children to JK, and sadly, we couldn't accommodate them either!

It is so exciting to see how our school has been growing! I am thrilled by the idea of a capital campaign to accommodate this growth! Classroom space and environment matter to the children who spend many hours in them; they matter to the teachers who plan, teach, and live in them; and they matter to families and visitors who pass through them!

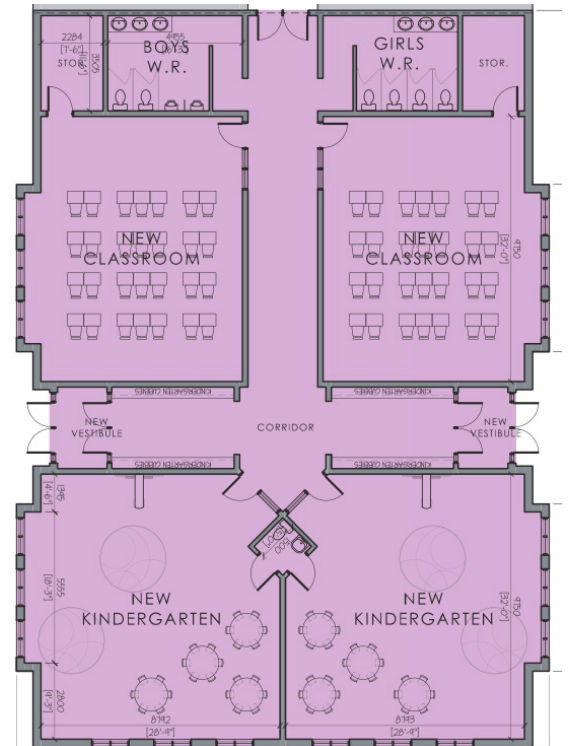

FREQUENTLY ASKED QUESTIONS

Where will the financial support come from?

Our schools have been in existence for more than 50 years and, with the Lord's blessing, will be around for many decades more. It is our intention through the campaign to include all of the generations involved at Cairn Christian School - past, present, and future. All current and past parents, grandparents, alumni, staff, volunteers, and past donors will be invited to support our vision for the future. Appropriate businesses and foundations will also be approached for their financial support. It is our intent to give everyone the opportunity to help build our legacy for the next 50+ years.

We give our heartfelt thanks to our Campaign volunteers, and their families, for sharing their time and talents with the *Building the Way* Campaign to ensure its success.

Building the Way Campaign Cabinet

- Wayne Schilstra, Chair
- Wendy Colyn
- Bonnie Desjardins, Principal, Stoney Creek
- Jessica Dreyer
- Richard Hoiting
- Kevin Huinink, Executive Director, Cairn
- Cheryl Janssen
- Joyce Koorneef, Principal, Smithville
- Duane VanGeest
- Danielle Vandenberg
- Rob van Wely